

Linx 5900 & 7900



How To Use a Different
Keyboard

LINX

THINKING ALONG YOUR LINES



Contents

1 Introduction	2
1.1 Health and Safety	2
2 Use a different keyboard	3
2.1 Language and keyboard options	3
2.1.1 Language	4
2.1.2 Use Language Defaults	4
2.1.3 Keyboard	4
2.1.4 Secondary Keyboard	5
3 Extended keyboard character sets	6
3.1 How to access different characters on a key	7
4 Additional character sets	9
4.1 Character selector	9
4.2 Pinyin system	11
4.2.1 Simplified Chinese Pinyin	11
4.2.2 Traditional Chinese Pinyin	13
4.3 Korean character selector	15
5 Keyboard layouts	19
5.1 European keyboard layout	19
5.2 European keyboard character set	19
5.3 Japanese keyboard layout	20
5.4 Japanese keyboard character set	20
5.5 Greek keyboard layout	21
5.6 Greek keyboard character set	21
5.7 Russian keyboard layout	22
5.8 Russian keyboard character set	22
5.9 Simplified Chinese keyboard layout	23
5.10 Simplified Chinese keyboard character set	23
5.11 Traditional Chinese keyboard layout	24
5.12 Traditional Chinese keyboard character set	24
5.13 Korean keyboard layout	25
5.14 Korean keyboard character set	25
5.15 Hebrew keyboard layout	26
5.16 Hebrew keyboard character set	26
5.17 Arabic keyboard layout	27
5.18 Arabic keyboard character set	27
5.19 Farsi keyboard layout	28
5.20 Farsi keyboard character set	28
5.21 Vietnamese keyboard layout	29
5.22 Vietnamese keyboard character set	29
5.23 Thai keyboard layout	31
5.24 Thai keyboard character set	31
5.25 Bulgarian keyboard layout	32
5.26 Bulgarian keyboard character set	32



1 Introduction

This document describes how to use different keyboards on the 5900 and 7900 printers. It tells you how to access the extended character sets from the keyboard and the additional character set through the character selector for the European keyboard. This document also tells you how to use the Pinyin system for Traditional and Simplified Chinese, and the Korean character selector.

You need a User Level C password to perform all the tasks described in this document.

NOTE: There are variations in the colours of the keys and characters on the 5900 and 7900 keyboards, but their layouts are identical.

1.1 Health and Safety

Make sure that you read and understand the Health and Safety information in the 'Safety' section of the *Linx 7900 Quick Start Guide*.



2 Use a different keyboard

The keyboard that is fitted to the 5900 and 7900 printers depends on the country where the printer is used. The 5900 and 7900 printers allow you to use the following keyboards:

- European
- Japanese
- Greek
- Russian
- Simplified Chinese
- Traditional Chinese
- Korean
- Hebrew
- Arabic
- Farsi
- Vietnamese
- Thai
- Bulgarian

See 'Keyboard layouts' on page 19 for more information about the layout of the keyboards, and their character sets.

You can set the language defaults that the printer uses, the type of keyboard that is fitted, and change the keyboard options.

2.1 Language and keyboard options

The following language and keyboard options are available:

- **Language**—This option sets the language that the printer software uses in all of the pages that are displayed. For example, menus, dialog boxes, and system messages. See 'Language' on page 4 for more information about this option.
- **Keyboard**—This option tells the printer the type of hardware keyboard that is fitted and controls the characters that appear when you press a key on the keyboard. See 'Keyboard' on page 4 for more information about this option.
- **Secondary Keyboard**—This option allows you to select a secondary keyboard layout that is different from the primary keyboard. For example, you can change between European and Japanese keyboards, which allows you to use a European keyboard to generate Japanese characters. See 'Secondary Keyboard' on page 5 for more information about this option.
- **Extended character set**—You can access an extended set of characters from the keys on the keyboard of the printer. See 'Extended keyboard character sets' on page 6 for more information about how to select these characters from the keyboard.

How To Use a Different Keyboard



- **Additional character set**—The European keyboard option includes a software function that allows you to generate additional characters that are not on the keyboard. See 'Additional character sets' on page 9 for more information about how to access these characters. To select the language and keyboard options that the printer uses:

At the **Print Monitor** page, select **Menu > Setup > Installation > Locale** to display the **Locale** page.

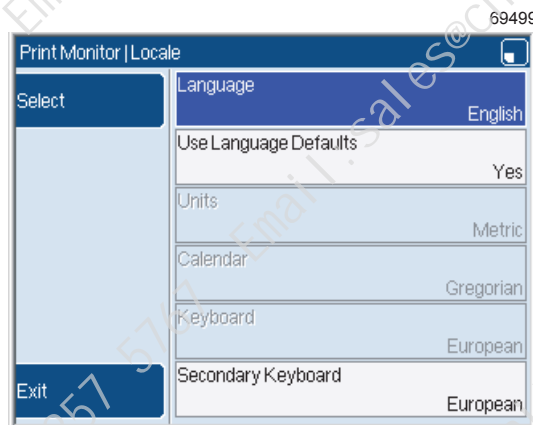

Figure 1. Locale page

2.1.1 Language

To set the **Language** option, first make sure that the printer is not in the 'PRINTING' state. Select the option to display the list of available languages, then press the **OK** key to return to the **Locale** page.

2.1.2 Use Language Defaults

If this option is set to 'Yes' the **Units**, **Calendar**, and **Keyboard** options are not available. The three options are set to default values that are correct for the language selected.

NOTE: The **Units** and **Calendar** options are described in *How To Change the System Setup*.

If the **Use Language Defaults** option is set to 'No', you can change the **Units**, **Calendar**, and **Keyboard** options. You can select a keyboard option that is different from the **Language** option for the printer. If you change the keyboard you can create a message in one language, but display the printer pages in another language.

For example, you can set the **Keyboard** option to Japanese, but set the **Language** option to English. When you use this combination of options, the message is displayed and printed in Japanese, but the printer display is in English.

2.1.3 Keyboard

The installation engineer sets the **Keyboard** option to match the hardware keyboard that is fitted at the factory. Normally you do not change this option, but the printer software allows you to change the keyboard that the printer uses.

For example, you can use this option to select a character that appears on other keyboards. If a European keyboard is fitted, but the **Keyboard** option is set to Japanese, the keyboard generates a Japanese character when you press a key.

How To Use a Different Keyboard



To change the keyboard that the software uses, select the keyboard from the list. Press the **OK** key to return to the **Locale** page.

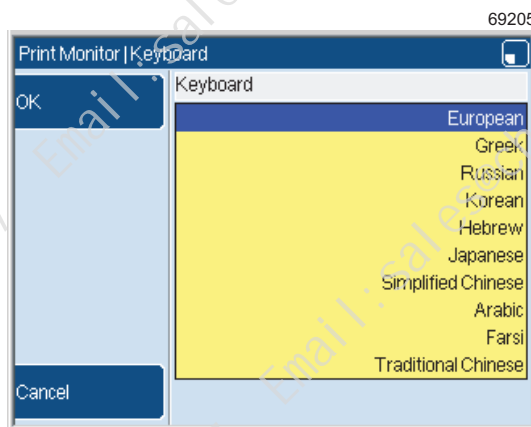

Figure 2. Keyboard page

2.1.4 Secondary Keyboard

To set a secondary keyboard that is different from the primary keyboard, select the secondary keyboard from the list and press the **OK** key to return to the **Locale** page.

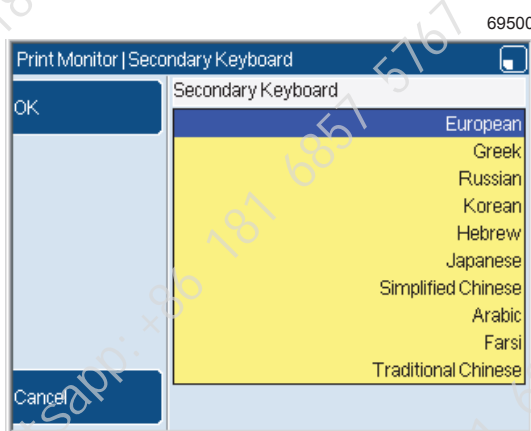

Figure 3. Secondary keyboard page

If a different secondary keyboard is selected, you can use the **[alt] + [k]** keyboard shortcut to change between the selected primary and secondary keyboards.



3 Extended keyboard character sets

The 5900 and 7900 printers allow you to select characters from extended character sets from the available keyboards. There are a maximum of four characters assigned to a key. Red letters or characters show the extended character keys on a keyboard. The following examples shows how you can access these characters.

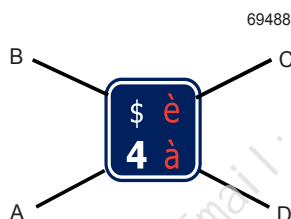

Figure 4. Example character layout on a key

NOTE: The red extended characters are in a different position on the keys on the Japanese keyboard (on the left side of the key and not on the right side of the key), as shown in Figure 5.

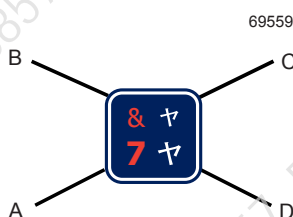

Figure 5. Character layout on a Japanese key



3.1 How to access different characters on a key

To access the characters on a key, refer to the following table.

Character position	Mode	Action
A: Bottom left	Default	Press the key to select the character at the bottom left.
B: Top left	Shift	Hold down the [shift] key and press the key to select the character at the top left. To lock the keyboard in this mode, hold down the [shift] key and press the [lock] key. To unlock the keyboard and return to the default mode, repeat this action.
C: Top right	Control and Shift	Hold down the [shift] and [ctrl] keys, and press the key to select the character at the top right. To lock the keyboard in this mode, hold down the [ctrl] key and [shift] key and press the [lock] key. To unlock the keyboard and return to the default mode, repeat this action.
D: Bottom right	Control	Hold down the [ctrl] key and press the key to select the character at the bottom right. To lock the keyboard in this mode, hold down the [ctrl] key and press the [lock] key. To unlock the keyboard and return to the default mode, repeat this action.

Figure 6. Keyboard character selection

See 'Keyboard layouts' on page 19 for more information about the extended character sets on keyboards.

The keyboard status indicator shows the current keyboard mode and which character is selected when you press the key. The indicator appears on the title bar at the top right of the screen, as shown in the following figures.



Figure 7. Keyboard status indicator: Default



Figure 8. Keyboard status indicator: Shift



Figure 9. Keyboard status indicator: Control and Shift

How To Use a Different Keyboard



Figure 10. Keyboard status indicator: Control

NOTE: When you press the [insert] key to set the printer display to overwrite mode, the background colour of the keyboard status indicator is white, not blue.

If the Japanese keyboard is selected, the keyboard status indicator appears as shown in the following figures:



Figure 11. Japanese keyboard indicator: Default



Figure 12. Japanese keyboard indicator: Shift



Figure 13. Japanese keyboard indicator: Control and Shift



Figure 14. Japanese keyboard indicator: Control

The character selector for the European keyboard allows you to access an additional character set that is not on the keyboard. This character set is shown in the table below

i	ç	œ	¥	©	a	«	¬
--	®	—	•	²	³	'	¶
ı	º	»	¼	½	¾	À	È
Ê	Â	Ë	Ì	Î	Ï	Ò	×
Ù	Ô	Ɔ	÷	ɓ	Ā ā	Ä	
Ê	ê	Ç	ć	Ǧ	Ē ē	ē	Ě
ě	É	è	Ę	Ě	Ĝ	ĝ	Ğ
ğ	Ḡ	ḡ	Ĥ	ĥ	H	ħ	Í
ī	Ī	ī	Ĳ	ŕ	l	ì	í
I	U	ij	Ĵ	ĵ	K	k	κ
Ł	Í	ł	J	L	Ł	Ł	N
ń	N	ņ	ñ	Ŋ	ŋ	Õ	ō
Ö	ö	Œ	œ	Ř	ř	R	r
Š	Ŝ	š	T	t	F	f	Ů
ū	Ū	ū	Ŭ	ŭ	V	v	Ŷ
ŵ	Ȳ	ȳ	Ỳ	ỳ	Ẑ	ẑ	

LINX

How To Use a Different Keyboard



You can use the [alt] + [x] keyboard shortcut from most text entry edit boxes to open the character selector.

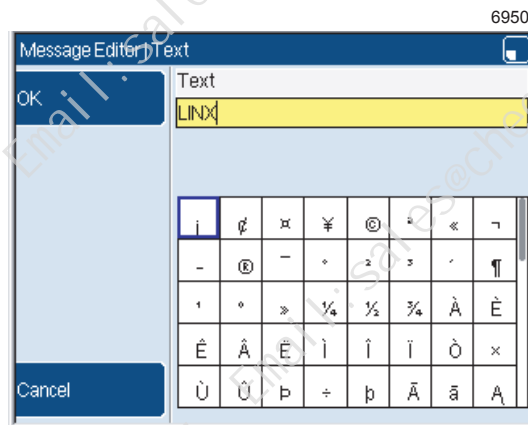

Figure 16. Text page: character selector

NOTE: Any text that you entered at the previous text entry edit box appears in the text box of the character selector.

Any characters that you now select in the character selector are displayed in the text box.

To use the character selector to select characters:

- 1 To move the cursor to the required character, hold down the [alt] key and the Up, Down, Left, or Right arrow key.
- 2 To select the character, press the [enter] key. The selected character is displayed in the text box at the current position of the cursor. You can continue to use the standard keyboard to enter characters in the text box.

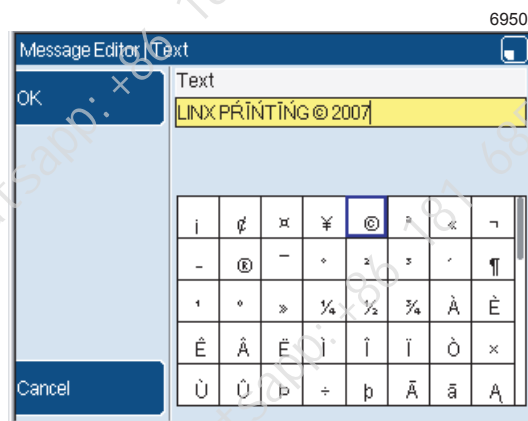

Figure 17. Text page: character selector with text



- 3 To finish with the standard and additional characters, press the **OK** key. The text that you entered is displayed in the text box.

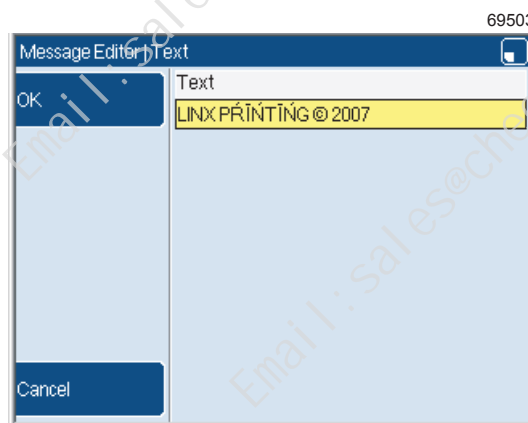

Figure 18. Text page

- 4 Press the **OK** key, then the **Exit** key to return to the **Message Editor** page.

4.2 Pinyin system

The Pinyin system for Simplified and Traditional Chinese allows you to enter combinations of Latin characters that match sounds in the Chinese language. When you enter Latin characters in the system, you can build Chinese characters phonetically.

NOTE: You can use the Pinyin system when you select a Simplified Chinese or Traditional Chinese primary or secondary keyboard.

4.2.1 Simplified Chinese Pinyin

To use the Pinyin system when you select a Simplified Chinese keyboard:

- 1 From a text edit entry box, use the [alt] + [x] keyboard shortcut to open the Pinyin system page. You can use the keyboard in 'Control' mode and 'Control and Shift' mode to enter Latin characters in the Pinyin system. See 'How to access different characters on a key' on page 7 for more information about how to select characters from the extended character sets on keyboards.

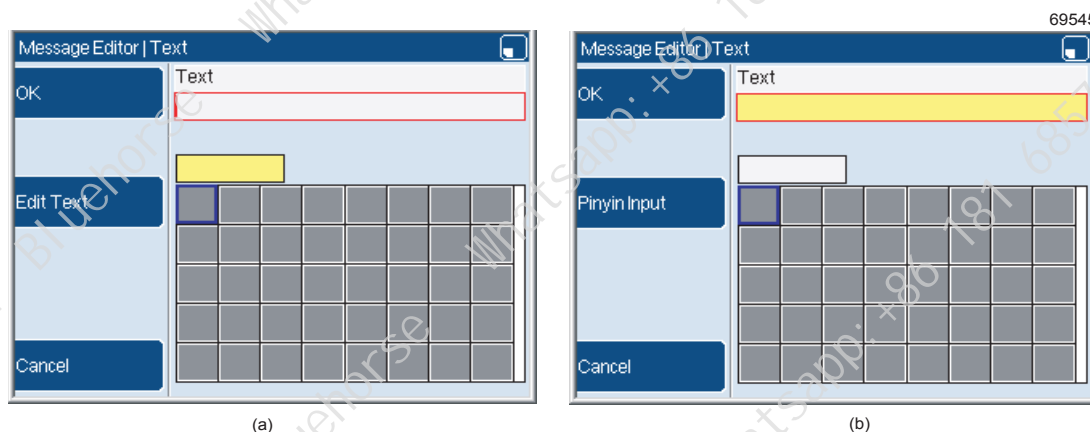

Figure 19. Text page: (a) Pinyin Input mode and (b) Edit Text mode

How To Use a Different Keyboard



- 2 The Pinyin system page opens in 'Pinyin Input' mode (see Figure 19 (a) on page 11). Press the **Edit Text** key to change to 'Edit Text' mode (see Figure 19 (b) on page 11). Press the key again to return to 'Pinyin Input' mode. The active text box has a yellow highlight. The two modes operate as follows:

- **Edit Text**—This option allows you to enter characters accessed from the selected current keyboard in 'Default' or 'Shift' mode in the upper text box. You can change between the two modes to add characters in 'Pinyin Input' mode. If necessary, use the Right arrow or Left arrow to move the cursor to the required position in the text box.
- **Pinyin Input**—This option allows you to enter Latin characters in the lower text box. When you enter each character in the box, the Simplified Chinese characters that match the entered text are displayed in the grid below.

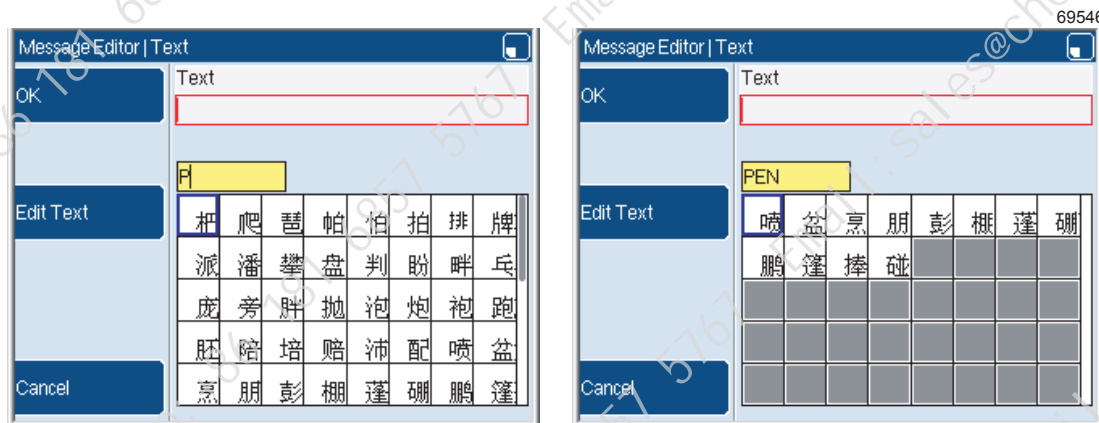

Figure 20. Text page: Pinyin character entry for Simplified Chinese (1)

- 3 To select the Simplified Chinese character that is highlighted in the grid, press the [enter] key. To move the cursor to highlight another Chinese character, hold down the [alt] key and the Up, Down, Left, or Right arrow key. Press the [enter] key to select the new character. The selected Chinese character is displayed in the upper text box at the current position of the cursor.

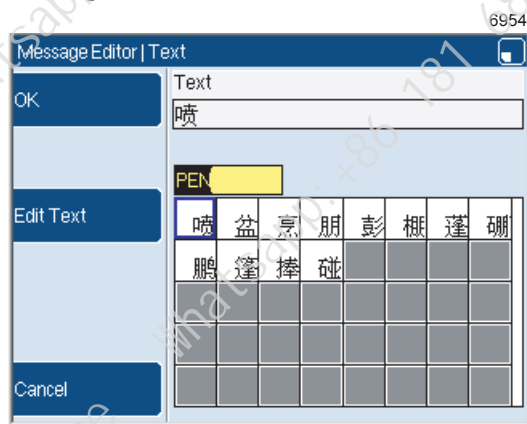

Figure 21. Text page: Pinyin character entry for Simplified Chinese (2)

To clear the highlighted text from the lower text box, press the [backspace] key or the [del] key, or enter another Latin character.



- 4 You can continue to use 'Pinyin Input' mode to build characters, or press the **Edit Text** key to change to 'Edit Text' mode. This option allows you to enter characters direct from the keyboard.
- 5 To finish with the Pinyin system page, press the **OK** key. The text that you entered is displayed in the text box.

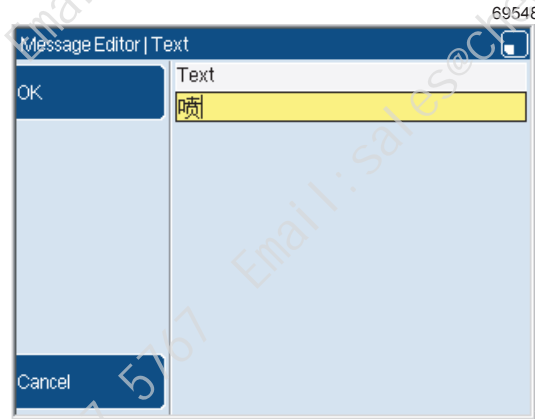

Figure 22. Text page with Simplified Chinese character

- 6 Press the **OK** key, then the **Exit** key to return to the **Message Editor** page.

4.2.2 Traditional Chinese Pinyin

To use the Pinyin system when you select a Traditional Chinese keyboard:

- 1 From a text entry edit box, use the [alt] + [x] keyboard shortcut to open the Pinyin system page. You can use the keyboard in 'Control' mode and 'Control and Shift' mode to enter Latin characters in the Pinyin system. See 'How to access different characters on a key' on page 7 for more information about how to select characters from the extended character sets on keyboards.
- 2 The Pinyin system page opens in 'Pinyin Input' mode (see Figure 19 (a) on page 11). Press the **Edit Text** key to change to 'Edit Text' mode (see Figure 19 (b) on page 11). Press the key again to return to 'Pinyin Input' mode. The active text box has a yellow highlight. The two modes operate as follows:
 - **Edit Text**—This option allows you to enter characters accessed from the selected current keyboard in 'Default' or 'Shift' mode in the upper text box. You can change between the two modes to add characters in 'Pinyin Input' mode. If necessary, use the Right arrow or Left arrow to move the cursor to the required position in the text box.

How To Use a Different Keyboard



- **Pinyin Input**—This option allows you to enter Latin characters in the lower text box. When you enter each character in the box, the Traditional Chinese characters that match the entered text are displayed in the grid below.

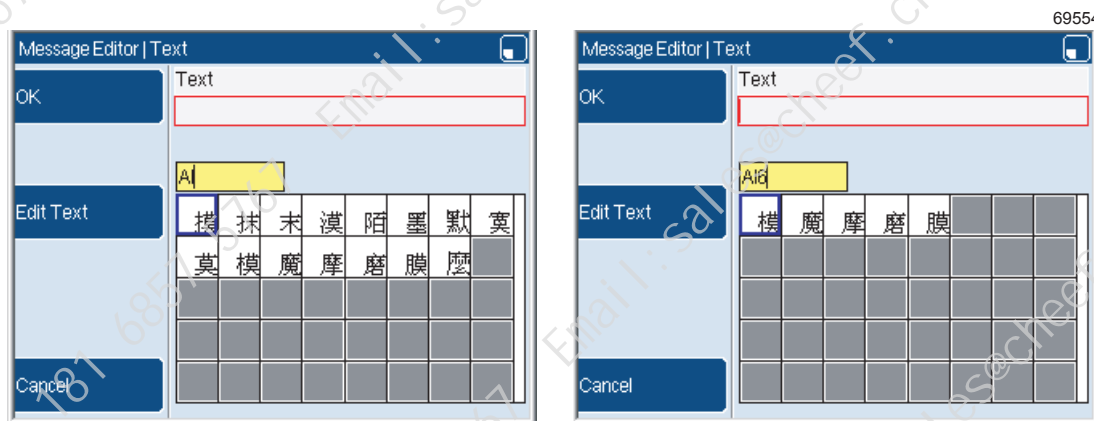

Figure 23. Text page: Pinyin character entry for Traditional Chinese (1)

- 3 To select the Traditional Chinese character that is highlighted in the grid, press the [enter] key. To move the cursor to highlight another Chinese character, hold down the [alt] key and the Up, Down, Left, or Right arrow key. Press the [enter] key to select the new character. The selected Chinese character is displayed in the upper text box at the current position of the cursor.

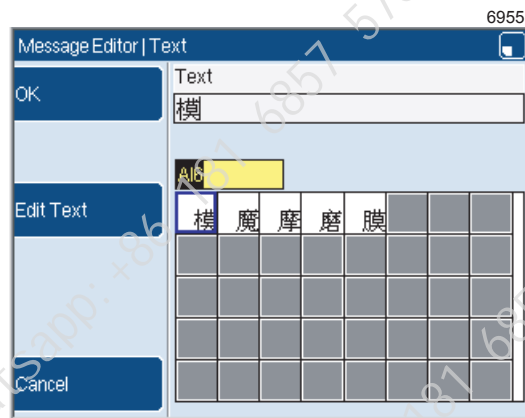

Figure 24. Text page: Pinyin character entry for Traditional Chinese (2)

To clear the highlighted character from the lower text box, press the [backspace] key or the [del] key, or enter another Latin character.

- 4 You can continue to use 'Pinyin Input' mode to build characters, or press the **Edit Text** key to change to 'Edit Text' mode. This option allows you to enter characters direct from the keyboard.



- 5 To finish with the Pinyin system page, press the **OK** key. The text that you entered is displayed in the text box.

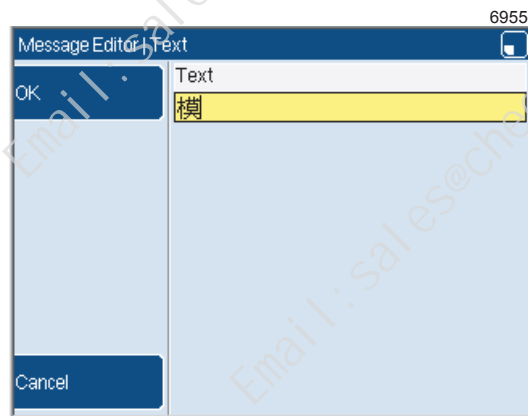

Figure 25. Text page with Traditional Chinese character

- 6 Press the **OK** key, then the **Exit** key to return to the **Message Editor** page.

4.3 Korean character selector

The Korean character selector allows you to create messages in Korean through Hangul syllables, built from characters known as Jamo. The Jamo are assembled from within the Korean character selector, which is like the Pinyin system.

NOTE: The printer only allows you to enter valid combinations of Jamo in the Korean character selector.

Example

You can use the Korean character selector when you select a Korean primary or secondary keyboard. This example uses English as the language option (European keyboard) with a Korean secondary keyboard selected.

How To Use a Different Keyboard



To use the Korean character selector:

- 1 From a text edit entry box use the [alt] + [k] keyboard shortcut to change to the Korean secondary keyboard. Enter any valid Jamo character in the text edit entry box. The Korean character selector automatically opens in 'Jamo Input' mode (see Figure 26). The character that you entered appears in the lower text box.

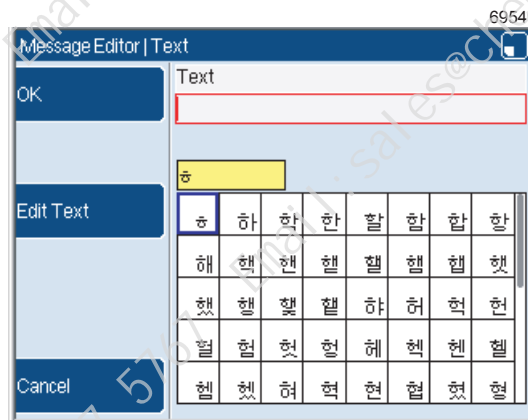

Figure 26. Korean character selector (1)

NOTE: You can press the **Edit Text** key to change to 'Edit Text' mode (see Figure 27(b)), but the Jamo characters that you enter again appear in the lower text box. Press the key again to return to the 'Jamo Input' option. The active text box has a yellow highlight.

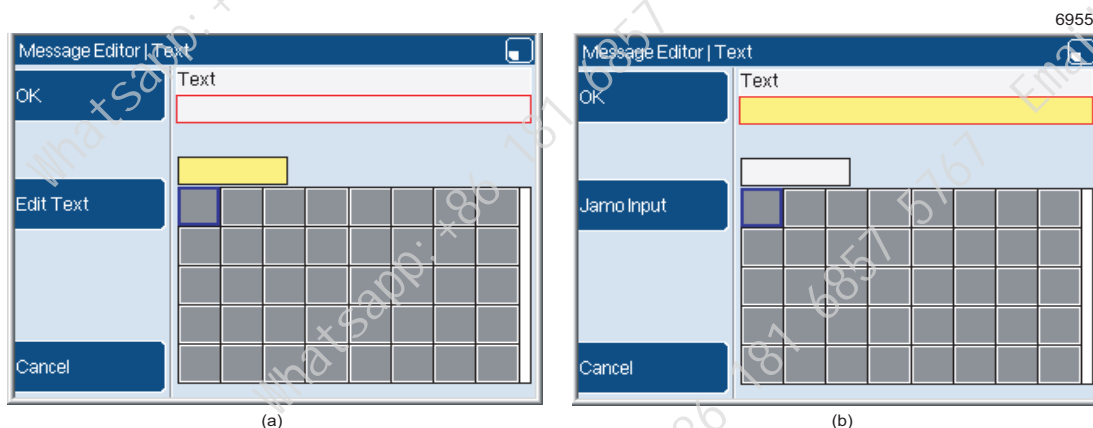

Figure 27. Korean character selector: (a) Jamo Input mode and (b) Edit Text mode

How To Use a Different Keyboard



- 2 Enter another valid Jamo character in the lower text box. When each Jamo character is entered in the box, valid future combinations of Jamo characters that form Hangul syllables are displayed in the grid below. You can select any one of these syllables as shown in step 3 of 'Simplified Chinese Pinyin' on page 12.

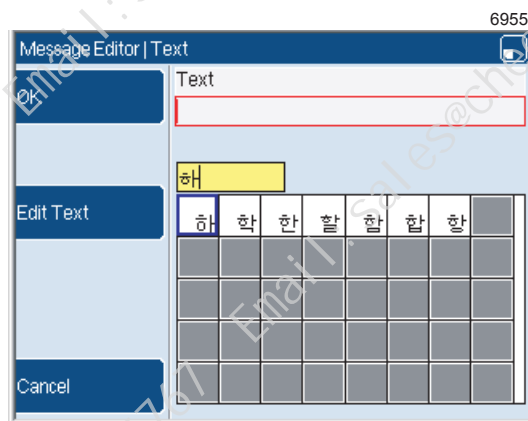

Figure 28. Korean character selector (2)

- 3 When you enter enough Jamo characters to leave one Hangul syllable in the grid, the syllable is moved to the upper text box at the current position of the cursor. The Jamo characters in the lower text box and Hangul syllables in the grid are cleared.

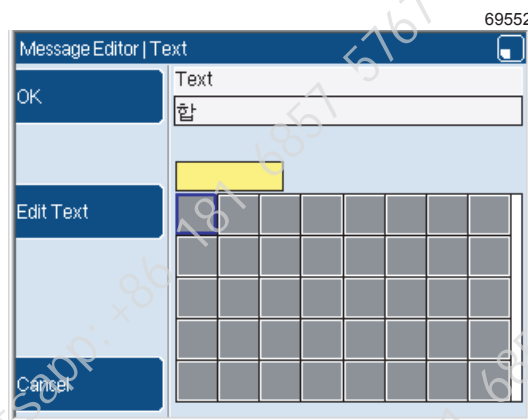

Figure 29. Korean character selector (3)

- 4 You can continue to use the Korean character selector to create Hangul syllables as required.

How To Use a Different Keyboard



- 5 To finish with the Korean character selector, press the **OK** key. The text that you entered is displayed in the text box.

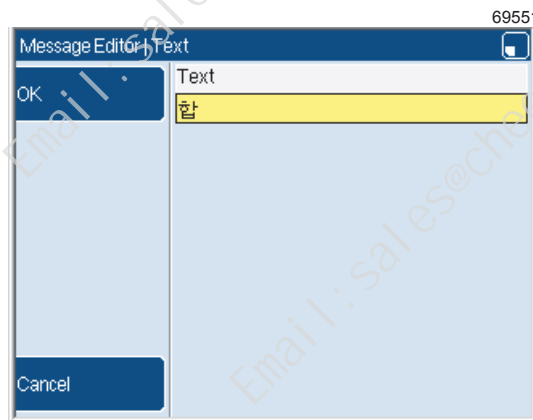

Figure 30. Text page with Korean Hangul syllable

- 6 Press the **OK**, then the **Exit** key to return to the **Message Editor** page.



5 Keyboard layouts

NOTE: Some of the characters that are shown in the figures for keyboard character sets do not appear on the keyboard. For example, lower case and upper case ASCII characters are shown, but only upper case ASCII characters appear on the keyboard.

5.1 European keyboard layout

The layout of the 5900/7900 European keyboard is shown in figure 31

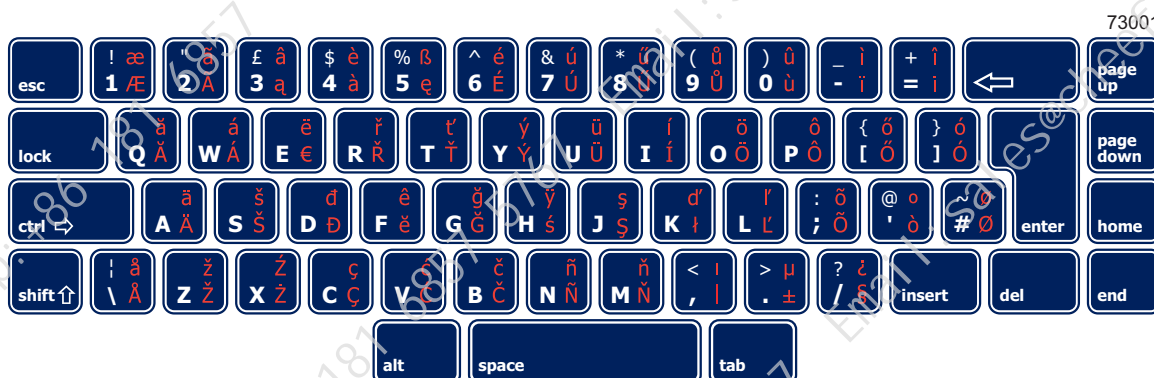

Figure 31. European keyboard layout

5.2 European keyboard character set

The table below shows the extended character set that you can access through the European keyboard as shown in 'How to access different characters on a key' on page 7.

69509

!	æ	“	ä	£	â	\$	è	%	ß	^	é	&	ú	*	ü	(û)	ù	-	ì	+	î
1	Æ	2	Ä	3	ä	4	à	5	ë	6	É	7	Ú	8	Ü	9	Û	0	ù	-	ï	=	í
q	ä	w	á	e	ë	r	ř	t	t'	y	ý	u	ü	i	í	o	ö	p	ô	{	õ	}	ó
Q	Ä	W	Á	E	€	R	Ř	T	Ť	Y	Ý	U	Ü	I	Í	O	Ö	P	Ô	[Ó]	Ó
a	ä	s	š	d	đ	f	ê	g	ğ	h	ÿ	j	ş	k	đ	l	l'	:	ö	@	°	~	ø
A	Ä	S	Š	D	Đ	F	?	G	Ğ	H	Ś	J	Ş	K	Đ	L	L'	;	Ö	'	ò	#	Ø
	å	z	ž	x	ž	c	ç	v	ć	b	č	n	ñ	m	ñ	<		>	µ	?	¿		
	Å	Z	Ž	X	Ž	C	Ç	V	Ć	B	Č	N	Ñ	M	Ñ	,		.	±	/	\$		

Figure 32. European keyboard character set



5.3 Japanese keyboard layout

The layout of the 5900/7900 Japanese keyboard is shown in Figure 33.



Figure 33. Japanese keyboard layout

5.4 Japanese keyboard character set

The table below shows the extended character set that you can access through the Japanese keyboard as shown in 'How to access different characters on a key' on page 7.

6952

個	旬	・	株	円	ア	時	ウ	%	エ	^	オ	&	ヤ	*	ユ	(ヨ)	ヲ	分	包	+	装
1	ヌ	2	フ	3	ア	4	ウ	5	エ	6	オ	7	ヤ	8	ユ	9	ヨ	0	ワ	-	ホ	=	ハ
q	製	w	造	e	イ	r	賞	t	味	y	使	u	用	i	有	o	効	p	保	消	証	費	持
Q	タ	W	テ	E	イ	R	ス	T	カ	Y	ン	U	ナ	I	二	O	ラ	P	セ	[・]	・
a	場	s	限	d	間	f	以	g	内	h	番	j	号	k	出	l	荷	品	庫	名	存	入	質
A	チ	S	ト	D	シ	F	ハ	G	キ	H	ク	J	マ	K	ノ	L	リ	:	レ	~	ケ	#	ム
迄	・	z	ツ	x	上	c	中	v	下	b	年	n	月	m	日	<	産	>	卵	?	口		
¥	ー	Z	ツ	X	サ	C	ソ	V	ヒ	B	コ	N	ミ	M	モ	,	ネ	.	ル	/	メ		

Figure 34. Japanese keyboard character set



5.5 Greek keyboard layout

The layout of the 5900/7900 Greek keyboard is shown in Figure 35.

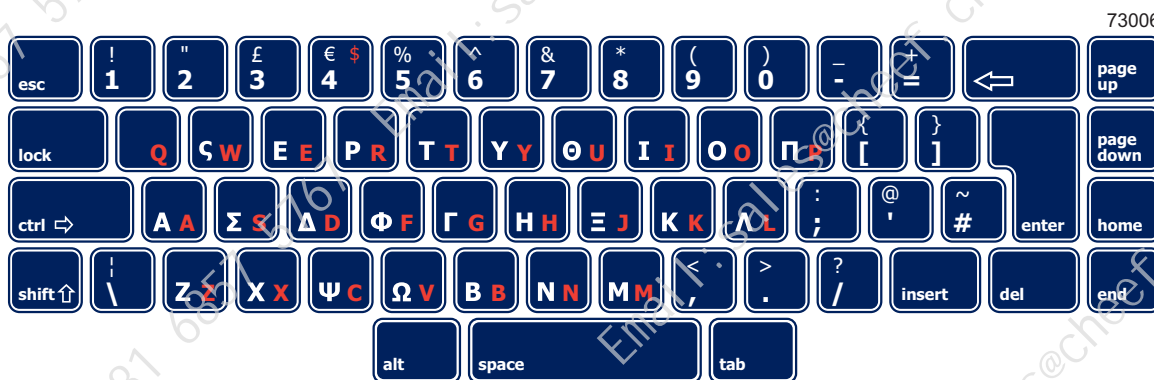

Figure 35. Greek keyboard layout

5.6 Greek keyboard character set

The table below shows the extended character set that you can access through the Greek keyboard as shown in 'How to access different characters on a key' on page 7.

!	!	"	"	£	£	€	\$	%	%	^	^	&	&	*	*	(())	-	-	+	+
1	1	2	2	3	3	4	4	5	5	6	6	7	7	8	8	9	9	0	0	-	-	=	=
	q	ς	ω	ε	ε	ρ	ρ	τ	τ	υ	υ	θ	θ	ι	ι	ο	ο	π	π	{	{	}	}
	Q	ς	W	E	E	P	P	T	T	Y	Y	Θ	Θ	I	I	O	O	Π	Π	[[]]
α	a	σ	s	δ	d	φ	f	γ	g	η	h	ξ	j	κ	k	λ	l	:	:	@	@	~	~
A	A	Σ	S	Δ	D	Φ	F	Γ	G	H	H	Ξ	J	K	K	Λ	L	;	;	'	'	#	#
		ζ	z	χ	x	ψ	c	ω	v	β	b	ν	n	μ	m	<	<	>	>	?	?		
		Z	Z	X	X	Ψ	C	Ω	V	B	B	N	N	M	M	,	,	.	.	/	/		

Figure 36. Greek keyboard character set



5.7 Russian keyboard layout

The layout of the 5900/7900 Russian keyboard is shown in Figure 37.



Figure 37. Russian keyboard layout

5.8 Russian keyboard character set

The table below shows the extended character set that you can access through the Russian keyboard as shown in 'How to access different characters on a key' on page 7.

!	!	"	"	£	£	€	\$	%	%	^	^	&	&	*	*	(())	-	-	+	+
1	1	2	2	3	3	4	4	5	5	6	6	7	7	8	8	9	9	0	0	-	-	=	=
й	q	ц	w	у	е	к	г	е	т	н	у	г	и	щ	і	щ	о	з	р	х	{	ъ	}
И	Q	Ц	W	У	Е	К	Р	Е	Т	Н	У	Г	И	Щ	О	З	Р	Х	[Ъ]		
ф	а	ы	с	в	д	а	ф	п	г	р	н	о	ј	д	к	д	л	ж	:	э	@	~	~
Ф	А	Ы	С	В	Д	А	Ф	П	Г	Р	Н	О	Ј	Л	К	Д	Л	Ж	;	Э	'	#	#
¥		я	z	ч	х	с	с	м	в	и	б	т	п	ь	м	б	<	ю	>	?	?		
¥		Я	Z	Ч	Х	С	С	М	В	И	Б	Т	Н	Ь	М	Б	,	Ю	.	/	/		

Figure 38. Russian keyboard character set



5.9 Simplified Chinese keyboard layout

The layout of the 5900/7900 Simplified Chinese keyboard is shown in Figure 39.



Figure 39. Simplified Chinese keyboard layout

5.10 Simplified Chinese keyboard character set

The table below shows the extended character set that you can access through the Simplified Chinese keyboard as shown in 'How to access different characters on a key' on page 7.

69532

®	!	™	"	¢	€	¥	\$	n/a	%	n/a	^	大	&	小	*	上	(下)	千	_	万	+
—	1	二	2	三	3	四	4	五	5	六	6	七	7	八	8	九	9	零	0	十	-	百	=
中	q	国	w	本	e	使	r	用	t	食	y	无	u	己	i	内	o	先	p	售	{	价	}
年	Q	月	W	日	E	时	R	分	T	秒	Y	前	U	后	I	有	O	效	P	期	[限]
包	a	装	s	尺	d	寸	f	升	g	米	h	斤	j	克	k	毫	l	厘	:	元	@	角	~
生	A	产	S	合	D	格	F	班	G	次	H	批	J	号	K	保	L	质	;	存	'	放	#
消		除	z	于	x	高	c	温	v	灭	b	菌	n	毒	m	素	<	罐	>	瓶	?		
此	\	为	Z	最	X	佳	C	制	V	造	B	公	N	司	M	正	,	品	.	货	/		

Figure 40. Simplified Chinese keyboard character set

NOTE: The characters that use the keys 5 and 6 in the 'Shift' mode (marked n/a) are symbols for the Canadian Safety Authority and the Underwriters Laboratory. Unicode characters do not exist for these symbols.



5.11 Traditional Chinese keyboard layout

The layout of the 5900/7900 Traditional Chinese keyboard is shown in Figure 41.



Figure 41. Traditional Chinese keyboard layout

5.12 Traditional Chinese keyboard character set

The table below shows the extended character set that you can access through the Traditional Chinese keyboard as shown in 'How to access different characters on a key' on page 7.

69533

↑	!	μ	°	∅	€	n/a	\$	Ω	%	®	^	™	&	n/a	*	n/a	(±)	°	-	℃	+
n/a	1	n/a	2	n/a	3	n/a	4	5	6	7	8	9	n/a	0	n/a	-	n/a	=					
製	q	造	w	有	e	效	r	期	t	限	y	年	u	月	i	日	o	售	p	價	{	元	}
安	Q	全	W	聯	E	社	R	福	T	則	Y	品	U	禁	I	止	O	轉	P	贈	[送]
生	a	產	s	最	d	佳	f	合	g	格	h	時	j	間	k	保	l	存	:	使	@	用	~
分	A	秒	S	克	D	斤	F	尺	G	厘	H	班	J	次	K	別	L	特	;	等	'	級	#
序		批	z	號	x	為	c	此	v	天	b	前	n	自	m	起	<	至	>	止	?		
建	\	議	Z	不	X	可	C	合	V	稅	B	回	N	收	M	質	,	証	.	單	/		

Figure 42. Traditional Chinese keyboard character set

NOTE: The characters that use the keys marked with n/a are symbols for the Canadian Safety Authority, Underwriters Laboratory, and other bodies. Unicode characters do not exist for these symbols.



5.13 Korean keyboard layout

The layout of the 5900/7900 Korean keyboard is shown in Figure 43.

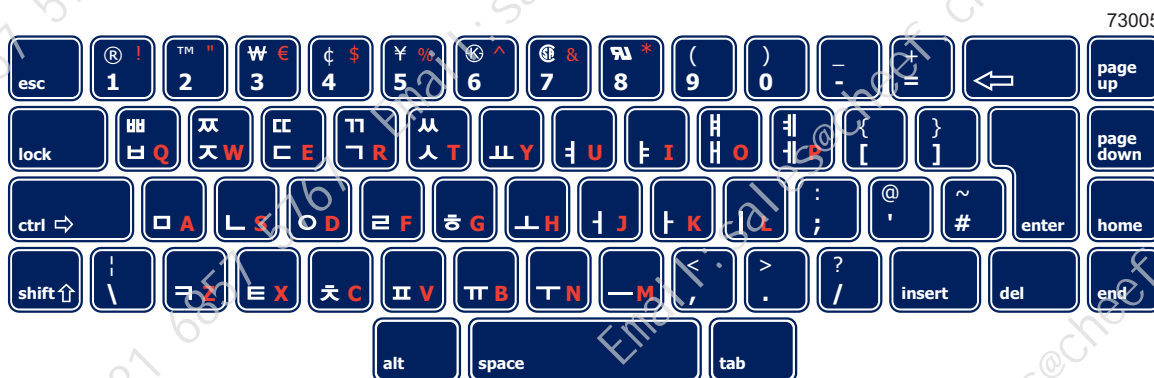

Figure 43. Korean keyboard layout

5.14 Korean keyboard character set

The table below shows the extended character set that you can access through the Korean keyboard as shown in 'How to access different characters on a key' on page 7.

Ⓢ	!	™	°	₩	€	¢	\$	¥	%	Ⓢ	^	n/a	&	n/a	*	(())	-	-	+	+
1	1	2	2	3	3	4	4	5	5	6	6	7	7	8	8	9	9	0	0	-	-	=	=
Ⓢ	q	ㅅ	ㅅ	ㅅ	ㅅ	ㅅ	ㅅ	ㅅ	ㅅ	ㅅ	ㅅ	ㅅ	ㅅ	ㅅ	ㅅ	ㅅ	ㅅ	ㅅ	ㅅ	{	{	}	}
ㅅ	Q	ㅅ	ㅅ	ㅅ	ㅅ	ㅅ	ㅅ	ㅅ	ㅅ	ㅅ	ㅅ	ㅅ	ㅅ	ㅅ	ㅅ	ㅅ	ㅅ	ㅅ	ㅅ	[[]]
	a		s		d		f		g		h		j		k		l	:	:	@	@	~	~
ㅅ	A	L	S	O	D	E	F	G	H	I	J	K	L	;	;	'	'	#	#				
			z		x		c		v		b		n		m	<	<	>	>	?	?		
\	\	ㅅ	Z	E	X	C	V	B	N	-	M	,	,	.	.	/	/						

Figure 44. Korean keyboard character set

NOTE: The characters that use the keys 7 and 8 in the 'Shift' mode (marked n/a) are symbols for the Canadian Safety Authority and the Underwriters Laboratory. Unicode characters do not exist for these symbols.



5.15 Hebrew keyboard layout

The layout of the 5900/7900 Hebrew keyboard is shown in Figure 45.

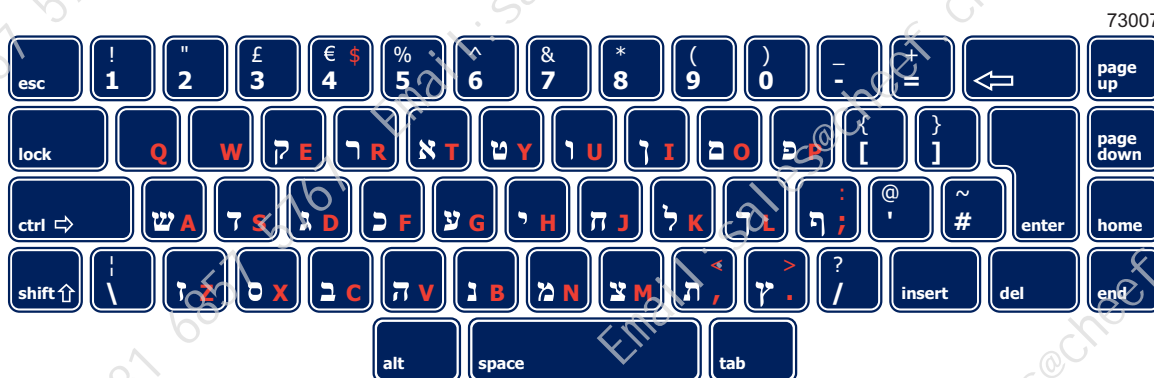

Figure 45. Hebrew keyboard layout

5.16 Hebrew keyboard character set

The table below shows the extended character set that you can access through the Hebrew keyboard as shown in 'How to access different characters on a key' on page 7.

69535

!	!	"	"	£	£	€	\$	%	%	^	^	&	&	*	*	(())	-	-	+	+
1	1	2	2	3	3	4	4	5	5	6	6	7	7	8	8	9	9	0	0	-	-	=	=
	q		w	p	e	ר	r	א	t	ו	y	י	u	ן	i	o	o	פ	p	{	{	}	}
	Q		W	P	E	ר	R	א	T	ו	Y	י	U	ן	I	O	O	פ	P	[[]]
ש	a	ט	s	ג	d	כ	f	ץ	g	י	h	נ	j	ל	k	ך	l	ך	:	@	@	~	~
ש	A	ט	S	ג	D	כ	F	ץ	G	י	H	נ	J	ל	K	ך	L	ך	:	'	'	#	#
		י	z	ס	x	ב	c	ה	v	נ	b	מ	n	צ	m	ת	<	ך	>	?	?		
\	\	י	Z	ס	X	ב	C	ה	V	נ	B	מ	N	צ	M	ת	.	ך	.	/	/		

Figure 46. Hebrew keyboard character set



5.17 Arabic keyboard layout

The layout of the 5900/7900 Arabic keyboard is shown in Figure 47.

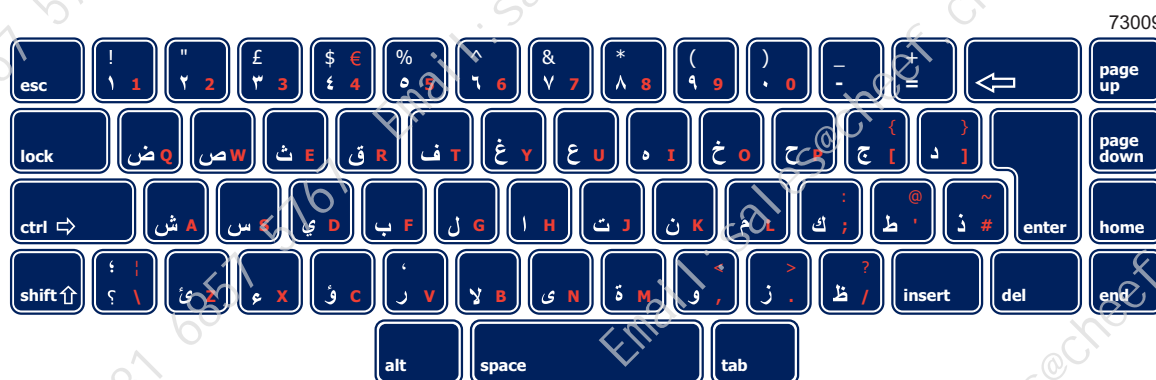

Figure 47. Arabic keyboard layout

5.18 Arabic keyboard character set

The table below shows the extended character set that you can access through the Arabic keyboard as shown in 'How to access different characters on a key' on page 7.

!	!	"	"	£	£	\$	€	%	%	^	^	&	&	*	*	(())	_	_	+	+
ı	1	ı	2	ı	3	£	4	0	5	ı	6	ı	7	A	8	ı	9	.	0	-	-	=	=
ض	q	ص	w	ث	e	ق	r	ف	t	غ	y	ع	u	o	i	خ	o	ح	p	ج	{	د	}
ض	Q	ص	W	ث	E	ق	R	ف	T	غ	Y	ع	U	o	I	خ	O	ح	P	ج	[د]
ش	a	س	s	ي	d	ب	f	J	g	ل	h	ت	j	ن	k	م	l	ك	:	ط	@	ذ	~
ش	A	س	S	ي	D	ب	F	J	G	ل	H	ت	J	ن	K	م	L	ك	:	ط	'	ذ	#
:		ئ	z	ء	x	ؤ	c	'	v	ي	b	ى	n	ō	m	و	<	ز	>	ظ	?		
؟	\	ئ	Z	ء	X	ؤ	C	,	V	ي	B	ى	N	ō	M	و	.	ز	.	ظ	/		

Figure 48. Arabic keyboard character set



5.19 Farsi keyboard layout

The layout of the 5900/7900 Farsi keyboard is shown in Figure 51.

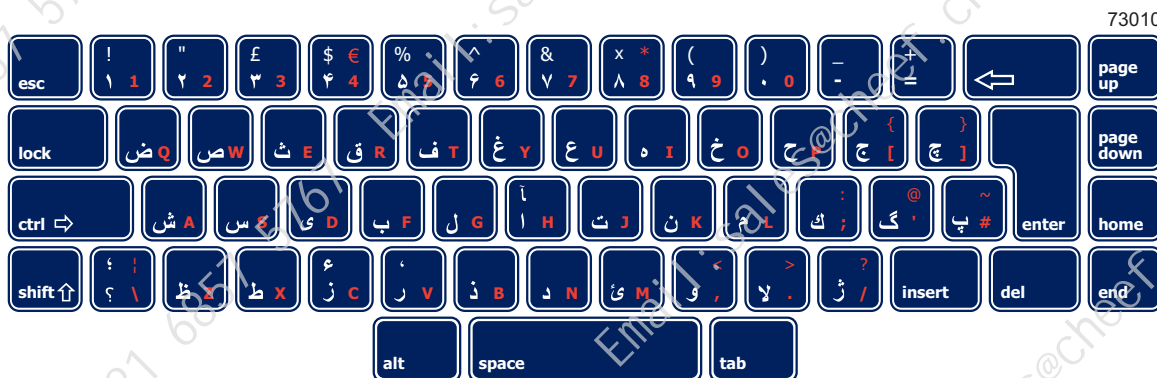

Figure 49. Farsi keyboard layout

5.20 Farsi keyboard character set

The table below shows the extended character set that you can access through the Farsi keyboard as shown in 'How to access different characters on a key' on page 7

69537

!	!	"	"	£	£	\$	€	%	%	^	^	&	&	x	*	(())	-	-	+	+
۱	1	۲	2	۳	3	۴	4	۵	5	۶	6	۷	7	۸	8	۹	9	۰	0	-	-	=	=
ض	q	ص	w	ث	e	ق	r	ف	t	غ	y	ع	u	و	i	خ	o	چ	p	ج	{	ج	}
ض	Q	ص	W	ث	E	ق	R	ف	T	غ	Y	ع	U	و	I	خ	O	چ	P	ج	[ج]
ش	a	س	s	ی	d	ب	f	ج	g	ا	h	ت	j	ن	k	م	l	ک	:	گ	@	پ	~
ش	A	س	S	ی	D	ب	F	ج	G	ا	H	ت	J	ن	K	م	L	ک	:	گ	'	پ	#
؛		ظ	z	ط	x	ع	c	ر	v	ذ	b	د	n	س	m	و	<	لا	>	ز	?		
؟	\	ظ	Z	ط	X	ر	C	ر	V	ذ	B	د	N	س	M	و	.	لا	.	ز	/		

Figure 50. Farsi keyboard character set



5.21 Vietnamese keyboard layout

The layout of the 5900/7900 Vietnamese keyboard is shown in Figure 51.

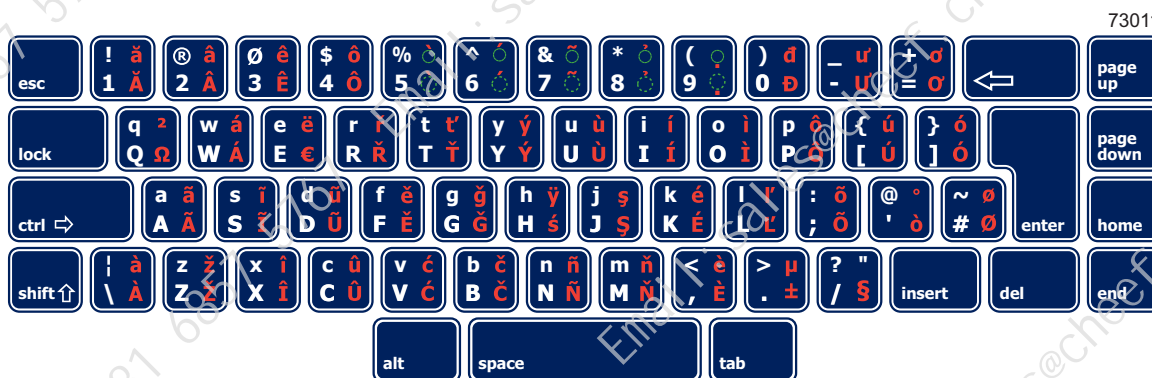

Figure 51. Vietnamese keyboard layout

5.22 Vietnamese keyboard character set

The table below shows the extended character set that you can access through the Vietnamese keyboard as shown in 'How to access different characters on a key' on page 7.

!	ă	@	â	ø	ê	\$	ô	%	ò	^	ó	&	õ	*	o	(ø)	ø	-	u	+	σ
1	Ă	2	Â	3	Ê	4	Ô	5	Ò	6	Ó	7	Õ	8	Ö	9	Q	0	Ð	-	U	=	σ
q	2	w	á	e	ë	r	ř	t	ť	y	ý	u	ù	i	í	o	ì	p	ô	{	ú	}	ó
Q	Q	W	Á	E	Ë	R	Ř	T	Ť	Y	Ý	U	Ù	I	Í	O	Ì	P	Ô	[Ú]	Ó
a	ã	s	í	d	ũ	f	ě	g	ğ	h	ý	j	ş	k	é	l	ı	:	õ	@	°	~	ø
A	Ã	S	İ	D	Ū	F	Ě	G	Ğ	H	Ś	J	Ş	K	É	L	İ	;	Õ	`	ò	#	Ø
ı	à	z	ž	x	î	c	û	v	ć	b	č	n	ñ	m	ň	<	è	>	µ	?	"		
\	À	Z	Ž	X	Î	C	Û	V	Ć	B	Č	N	Ñ	M	Ň	,	È	.	±	/	§		

Figure 52. Vietnamese keyboard character set

NOTE: The Vietnamese language can change the meaning of some words through the characters A, E, I, O, U, and Y (upper case and lower case) combined with diacritic marks.

You access these diacritic marks (grave accent, acute accent, hook, tilde, or dot below) on the keyboard through the keys 5 to 9 in 'Control' mode (for upper case characters) and 'Control and Shift' mode (for lower case characters). Enter the character to change, then the diacritic mark you require. The diacritic mark is added to the character.

How To Use a Different Keyboard



Valid combinations of characters and diacritic marks are shown in the following table:

69125

	Modifier Key 5	Modifier Key 6	Modifier Key 8	Modifier Key 7	Modifier Key 9
	`	´	,	~	.
Character					
A/a	À/à	Á/á	Â/â	Ã/ã	Ä/ä
Ã/ã	À/à	Á/á	Â/â	Ã/ã	Ä/ä
Â/â	À/à	Á/á	Â/â	Ã/ã	Ä/ä
E/e	É/é	È/è	Ê/ê	Ë/ë	Ė/ė
Ê/ê	É/é	È/è	Ê/ê	Ë/ë	Ė/ė
I/i	Í/í	Ì/ì	Î/î	Ï/ï	İ/ı
O/o	Ó/ó	Ò/ò	Ô/ô	Õ/õ	Ơ/ơ
Ô/ô	Ó/ó	Ò/ò	Ô/ô	Õ/õ	Ơ/ơ
Ơ/ơ	Ó/ó	Ò/ò	Ô/ô	Õ/õ	Ơ/ơ
U/u	Ú/ú	Ù/ù	Û/û	Ü/ü	Ư/ư
Ư/ư	Ú/ú	Ù/ù	Û/û	Ü/ü	Ư/ư
Y/y	Ý/ý	Ỡ/ỡ	Ỡ/ỡ	Ỡ/ỡ	Ỡ/ỡ

Figure 53. Vietnamese diacritic marks



5.23 Thai keyboard layout

The layout of the 5900/7900 Thai keyboard is shown in Figure 54.

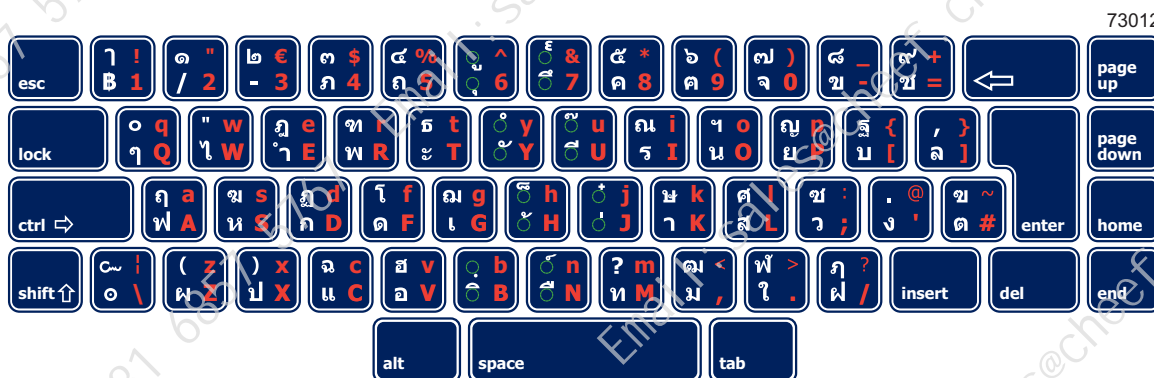

Figure 54. Thai keyboard layout

5.24 Thai keyboard character set

The table below shows the extended character set that you can access through the Thai keyboard as shown in 'How to access different characters on a key' on page 7.

[illegible]

Figure 55. Thai keyboard character set

NOTE: The Thai language uses a combination of characters with diacritic and tone marks to build text. You access these diacritic and tone marks on the keyboard in Default or Shift mode to create characters.



5.25 Bulgarian keyboard layout

The layout of the 5900/7900 Bulgarian keyboard is shown in Figure 54.



Figure 56. Bulgarian keyboard layout

5.26 Bulgarian keyboard character set

The table below shows the extended character set that you can access through the Bulgarian keyboard as shown in 'How to access different characters on a key' on page 7.

!	"	£	\$	%	^	&	*	()	-	+
1	2	3	4	5	6	7	8	9	0	Nº	=
q	w	e	r	t	y	u	i	o	d	p	{
Q	W	E	R	T	Y	U	I	O	D	P	[
a	s	d	f	g	h	j	k	l	:	@	~
A	S	D	F	G	H	J	K	L	:	@	#
;	z	x	v	c	b	n	m	<	>	?	/
\	Z	X	V	C	B	N	M	,	.	/	

Figure 57. Bulgarian keyboard character set